



**Procurement Office**  
675 West Main Street  
Rochester, NY 14611  
585-697-3625  
Fax: 585-697-7164  
[WWW.ROCHESTERHOUSING.ORG](http://WWW.ROCHESTERHOUSING.ORG)

January 20, 2014

To: Contractors

RE: Rochester Housing Authority,  
**Atlantic Townhouse Roof Replacement**

**ADDENDUM #1**

Please find attached addendum #1 to the above-mentioned Project. (6) pages including cover.

RHA is expecting to have the Pre-Construction Conference for this job on or around March 17, 2014 to sign contracts. The Pre-Construction date is the start date of the project. RHA expects that Contractor will be on site working on or before April 15, 2014.

**SEE ATTACHED**

**Acknowledgement:**

**I have received the above referenced Addendum #1, and have used it in the calculation/preparation of this bid.**

\_\_\_\_\_  
Contractor

**THIS MUST BE SUBMITTED WITH YOUR BID SUBMISSION**  
**FAILURE TO DO SO MAY RENDER YOUR BID INVALID.**

**Rochester Housing Authority  
Atlantic Ave. Townhouses – Roof Replacement  
HUNT 2285-015**

**ADDENDUM No. 1**

**Date:** January 15, 2014

The following Addendum (Addenda) shall be considered a part of the contract documents prepared by HUNT ENGINEERS, ARCHITECTS & LAND SURVEYORS, P.C. dated **December 20, 2013**.

**Revisions to Drawings:**

**Amend** detail 1/A1.3 with detail shown on AD-A1.  
**Amend** detail 2/A1.3 with detail shown on AD-A2.  
**Amend** detail 5/A1.3 with detail shown on AD-A3.

**Drawings Issued by this Addendum:**

**AD-A1  
AD-A2  
AD-A3**

**Project Manual Sections Issued by this Addendum:**

**None**

**Revisions to Project Manual:**

**None**

**Questions Asked at Pre-Bid Walk Through:**

1. **Q:** Is GAF Seal-a-Ridge Ridge Cap acceptable?  
**A:** Undetermined at this time. Contractors are permitted to submit "or equal" products for review and approval during the project.
  
2. **Q:** Is RHINO synthetic underlayment acceptable? (Their website states that it meets ASTM D226 Standards)  
**A:** Undetermined at this time. Contractors are permitted to submit "or equal" products for review and approval during the project.
  
3. **Q:** Is GEOCELL 2300 Tripolymer sealant acceptable?  
**A:** Undetermined at this time. Contractors are permitted to submit "or equal" products for review and approval during the project.
  
4. **Q:** Are we painting the entire chimney?  
**A:** Yes.
  
5. **Q:** Is it necessary to leave a full gallon of chimney paint behind?  
**A:** Yes.
  
6. **Q:** Does the storm collar and flange for the furnace exhaust flue pipes have to be replaced?  
**A:** Yes; everything that makes the new roof assembly water tight (flashing, boots, collars, etc.) above the roof framing needs to be replaced.

7. **Q:** The specifications do not state anything about the exhaust flue pipe caps. Are they to be replaced or reused? In my experience, it is often not possible to reuse the caps because of deterioration.  
**A:** All existing caps shall be replaced as required to install new collars.
8. **Q:** In the Side Eave Detail, it shows the exterior grade sheeting almost flush with the fascia board. This could pose a problem as the metal depicted in the drawing will be in the gutter on one end of the roof and not the other when the gutters are pitched properly. Should the sheeting be extended 3/4 inch past the fascia board and use F5 drip metal instead of C51/2?  
**A:** Refer to AD-A2 for a revised detail.
9. **Q:** This question may not pertain to you, but maybe you can help clarify it. I noticed on page 1 or 9 of the labor rates section the "Construction Type" is stated as Residential. Is this correct?  
**A:** Yes.

N:\2285-015\_V-CONTRACT DOCSVC-BID ADDENDUMBid Addendum #1.doc

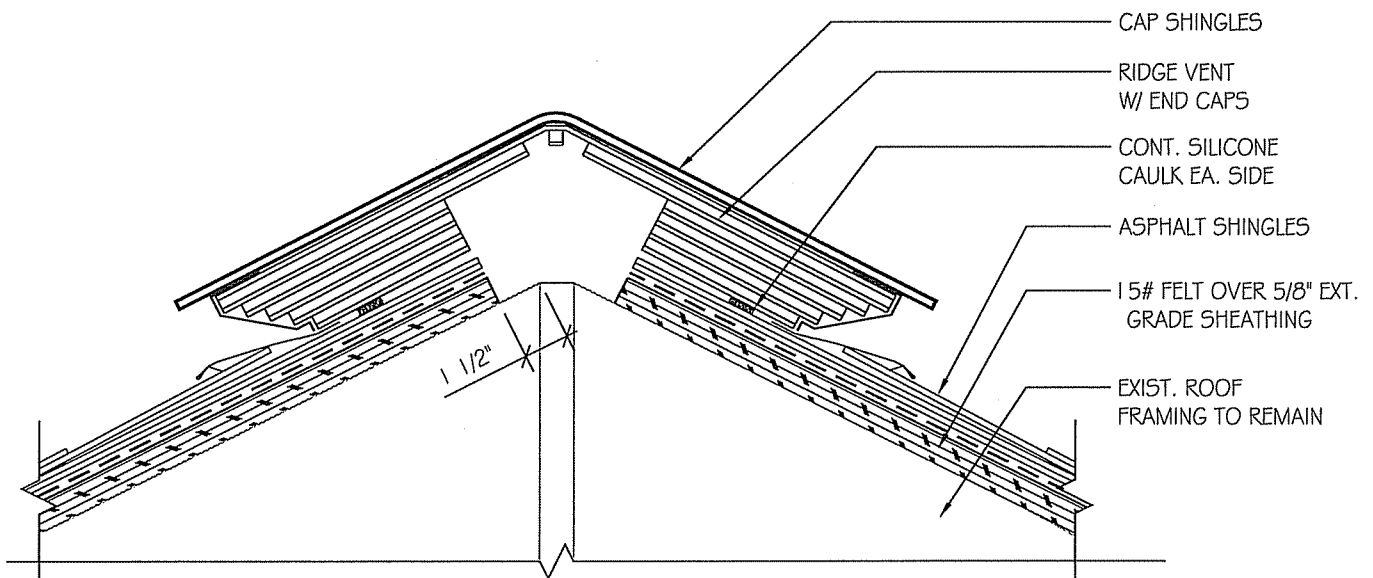

**1 RIDGE VENT DETAIL**  
 3" = 1'-0"

NOTE: CONTRACTOR SHALL INSTALL RIDGE VENT AS PER MANUFACTURER'S INSTRUCTIONS; SILICONE CAULK MAY NOT BE REQUIRED.

<p>RIDGE VENT DETAIL          ROCHESTER HOUSING AUTHORITY          ATLANTIC AVE. - ROOF REPLACEMENT          ROCHESTER, NY 14607</p>	<p><b>HUNT</b>  <small>ENGINEERS/ARCHITECTS/SURVEYORS</small>          4 COMMERCIAL STREET          SUITE 300, 3RD FLOOR          ROCHESTER, N.Y. 14614          585 - 327 - 7950          FAX - 327 - 7949          HORSEHEADS, NY      ROCHESTER, NY      TOWANDA, PA</p>	<p><b>AD-A1</b>          DATE:          1/15/2014          PROJECT NO:          2285-015</p>
--	---	--

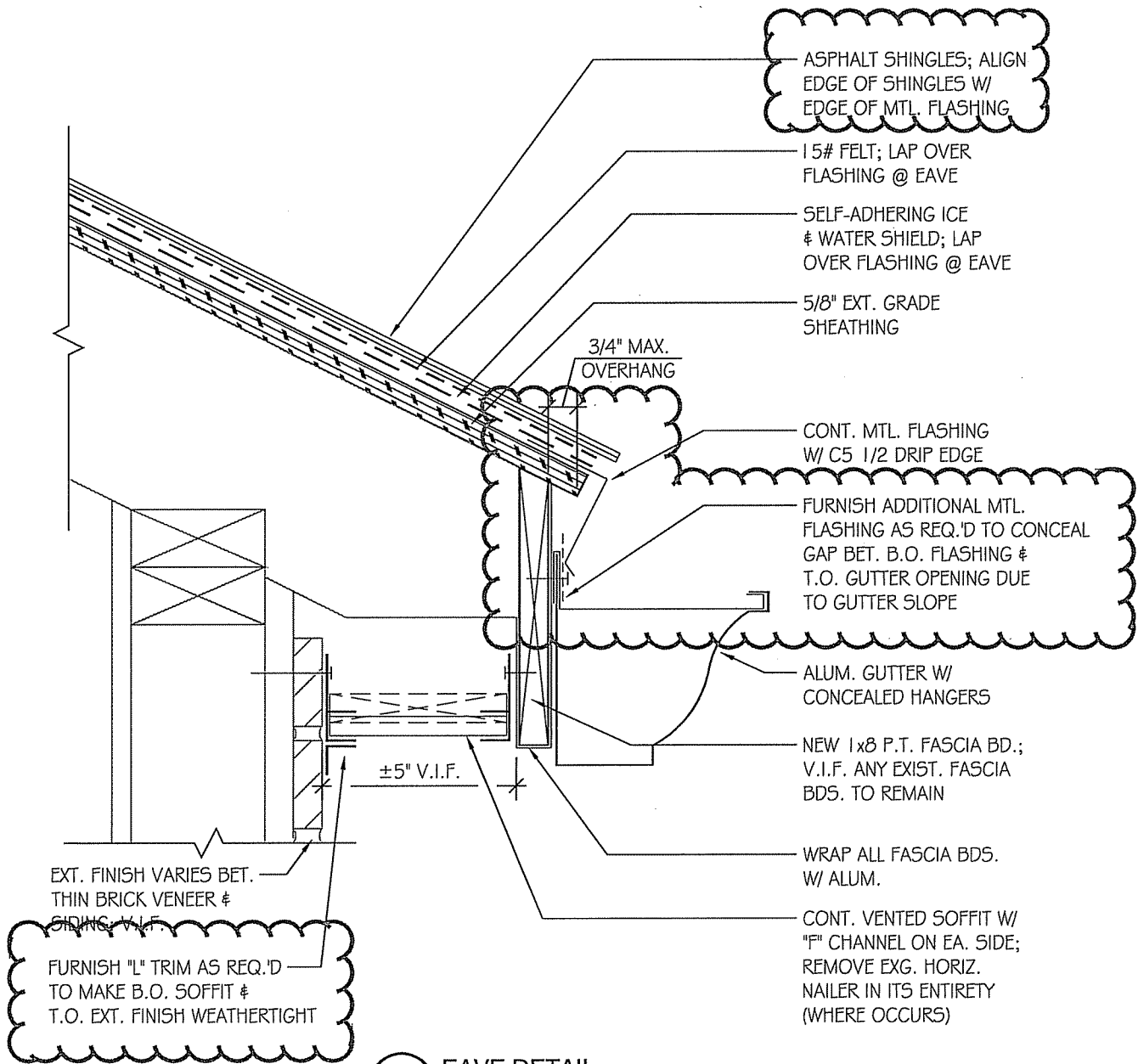

**2 EAVE DETAIL**  
3"=1'-0"

NOTES:

1. CONTRACTOR SHALL VERIFY EXISTING EAVE ASSEMBLY AFTER DEMOLITION & PRIOR TO INSTALLING NEW WORK.
2. CONTRACTOR IS RESPONSIBLE FOR ENSURING ROOF EDGE IS CONTINUOUSLY FLASHED INTO THE GUTTER.

<p><b>EAVE DETAIL</b>  <b>ROCHESTER HOUSING AUTHORITY</b>  <b>ATLANTIC AVE. - ROOF REPLACEMENT</b>          ROCHESTER, NY 14607</p>	<p><b>HUNT</b>  <small>ENGINEERS/ARCHITECTS/SURVEYORS</small></p> <p>4 COMMERCIAL STREET          SUITE 300, 3RD FLOOR          ROCHESTER, N.Y. 14614          585 - 327 - 7950          FAX - 327 - 7949</p> <p>HORSEHEADS, NY      ROCHESTER, NY      TOWANDA, PA</p>	<p><b>AD-A2</b></p> <p>DATE: 1/15/2014</p> <p>PROJECT NO: 2265-015</p>
---	---	--

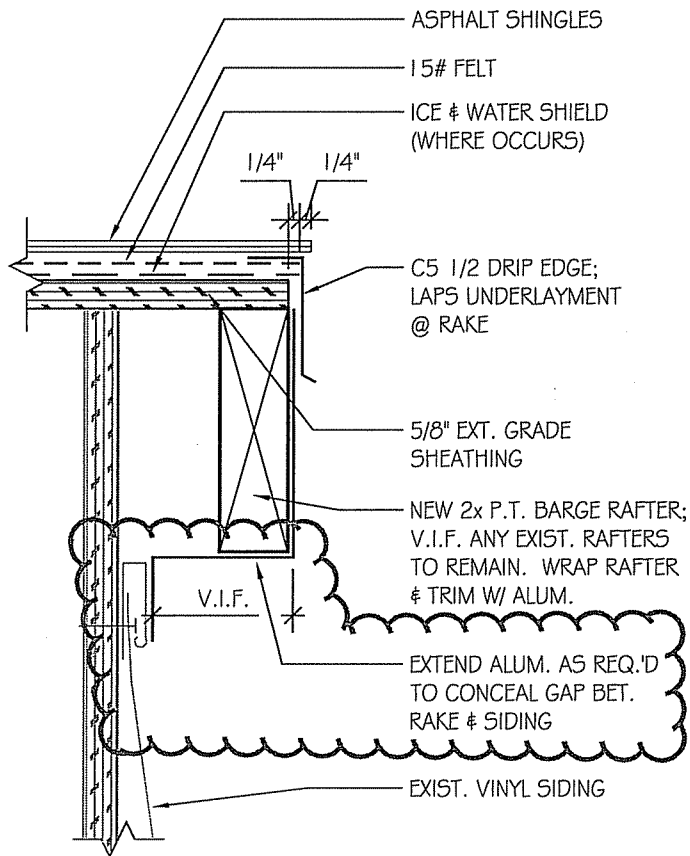

**5** **RAKE DETAIL**  
3" = 1'-0"

**RAKE DETAIL**

**ROCHESTER HOUSING AUTHORITY**  
**ATLANTIC AVE. - ROOF REPLACEMENT**  
ROCHESTER, NY 14607

Copyright: 2014



4 COMMERCIAL STREET  
SUITE 300, 3RD FLOOR  
ROCHESTER, N.Y. 14614  
585 · 327 · 7950  
FAX · 327 · 7949

HORSEHEADS, NY      ROCHESTER, NY      TOWANDA, PA

**AD-A3**

DATE:  
1/15/2014

PROJECT NO:  
2285-015